

Electro Fishing Survey

6-4-41

Yimber
 Kubistak
 Wisconsin Biological Survey

LAKE MALBERG
 SECTION 19, 20, 29
 TOWNSHIP 37 N
 RANGE 8 E
 TOWN OF NEWBOLD
 COUNTY ONEIDA

Sheet 242



AREA: 238 Acres ± 36.0
 TOTAL SHORELINE: 8.3 Miles ± 1.0
 MAX DEPTH: 45 Feet
 SCALE: 1" = 400'

DATE March 25, 1940
 COMPILED BY O.S.B.
 TRACED BY T.L.B. C.C.C.
 SOURCE OF INFORMATION U.S.G.S. Lake Investigation
Map of the State of Wisconsin
 SOUNDINGS 12.5" Intervals
 DATES OF MAP REVISION _____
 WORK AGENCY W.P.A.

LAKE IMPROVEMENT RECORD	TYPE	DATE
<input type="checkbox"/>	BRUSH REFUGES	<u>1927</u>
<input type="checkbox"/>	SAPLING TANGLES	<u>1925</u>
<input type="checkbox"/>	SPAWNING BOXES	
<input type="checkbox"/>	SPAWNERS	<u>200</u>
<input type="checkbox"/>	MINNOW	
<input type="checkbox"/>	TOTAL	<u>574</u>

LEGEND
<input type="checkbox"/> WEED BEDS
<input type="checkbox"/> ROCKY SHOALS
<input type="checkbox"/> SAND
<input type="checkbox"/> CLAY
<input type="checkbox"/> GRAVEL
<input type="checkbox"/> MUD
<input type="checkbox"/> DWELLING
<input type="checkbox"/> ABANDONED DWELLING
<input type="checkbox"/> RESORT

LAKE MILBROD
SECTION 19, P. 4
TOWNSHIP 37 N
RANGE 7-8 E
TOWN OF NEWBOLD
COUNTY ONEIDA
Sheet 181

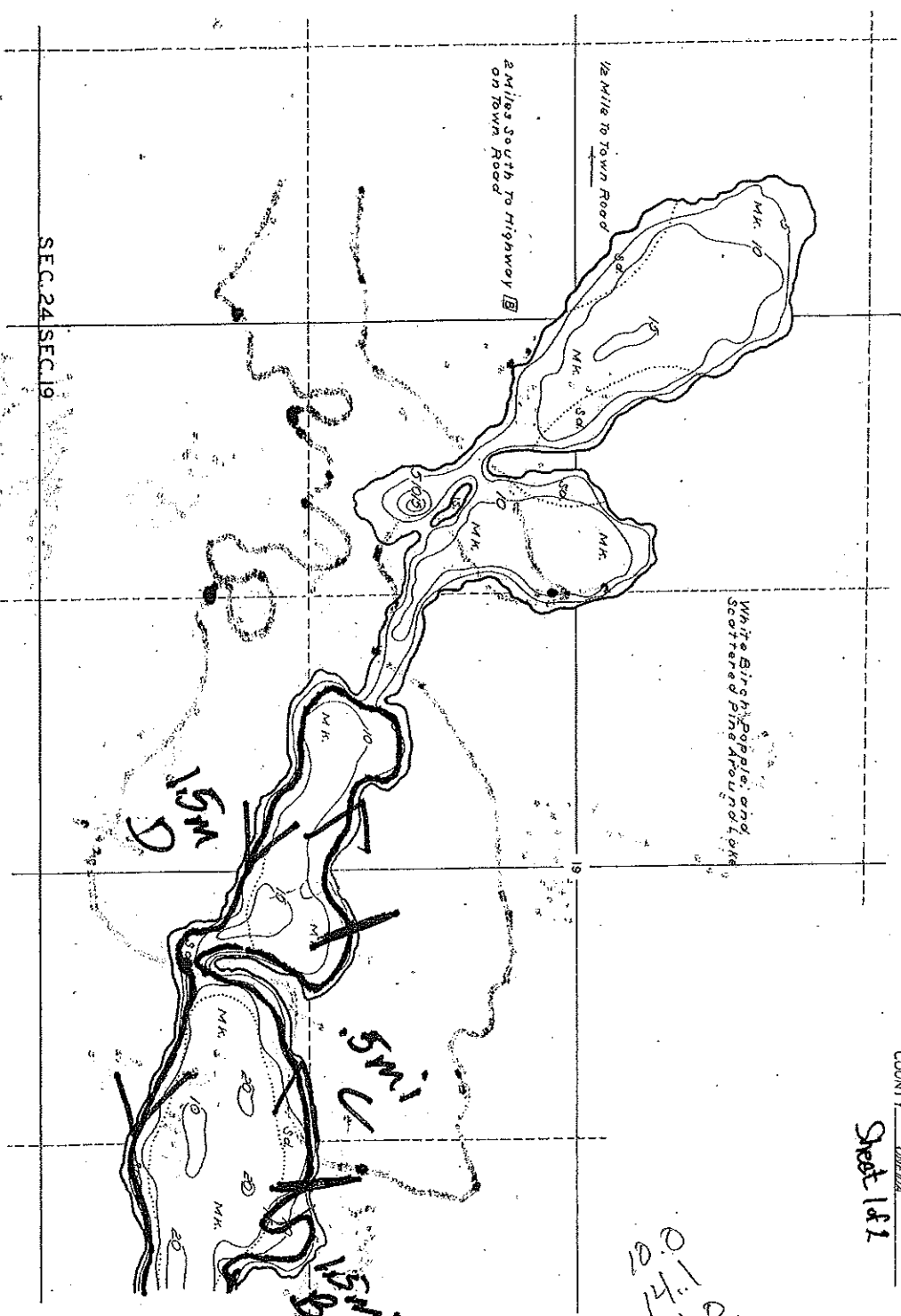

12.6
12.5
13.1
10.0
11.4
14.0
14.5
16.0

1-10
2-12
3-14
4-16
5-18
6-20

DATE March 25, 1960
COMPILED BY ZLR JCC
SOURCE OF INFORMATION WBA Lake Survey
Report by B. G. St. Pierre
SOUNDINGS 12.5' Intervals
DATES OF MAP REVISION _____
WORK AGENCY WBA

LAKE IMPROVEMENT RECORD	DATE	TYPE
<input type="checkbox"/> BRUSH REFUGES	<u>12</u>	
<input type="checkbox"/> SAPLING TANGLES	<u>12</u>	
<input type="checkbox"/> SPAWNING BOXES		
* MINNOW SPAWNS	<u>22</u>	
TOTAL	<u>22</u>	

AREA: 296.24 acres
TOTAL SHORELINE: 62721 feet
MAX. DEPTH: 4.5 feet
SCALE: 1" = 400'

LEGEND

- WEED BEDS
- ROCKY SHOALS
- SAND
- CLAY
- GRAVEL
- MUCK
- DWELLING
- ABANDONED DWELLING
- RESORT

Waterbody Name: Mildred
 MWB Code/WBIC: 1004600
 Waterbody Type: Lake
 County: Oneida
 Date (MM/DD/YY): 6-4-14
 Station: A
 Start Time: 21:18
 End Time: 21:37
 Collectors: Umler
Y. Piskal
Andrew

Target Fish: All Species
 Mark(s) Given: None
 Survey Type: GPE (Fall Shoreline) baseline
 Gear Type: Boomsucker
 Weather: Partly Cloudy, warm, calm
 Adverse Conditions: low conductivity, low water
 Water Temperature: let 18
 Water Conductivity: let 18
 Water Level: [HI] [NORM] [LOW]
 Water Clarity: 8.04
 Substrate Type:

Generator Start Time:
 Generator End Time:
 Volts: 534
 Amps: 1.5
 Pulse Rate:
 Duty Cycle:
 Current Type: [AC] [DC] [PDC]
 Distance Shocked: 25m
 Entire Shoreline Shocked: [M] [N] [I]
 Number of Dippers: 2 [1] [2]
 Dipnet Mesh Size: 19 brown

17 min

SPECIES				SPECIES			
INCHES	SMB	Bluegill		INCHES	IMB		
0.0-0.4				0.0-0.4			
0.5-0.9				0.5-0.9			
1.0-1.4				1.0-1.4			
1.5-1.9				1.5-1.9			
2.0-2.4				2.0-2.4			
2.5-2.9				2.5-2.9			
3.0-3.4				3.0-3.4			
3.5-3.9				3.5-3.9			
4.0-4.4				4.0-4.4			
4.5-4.9				4.5-4.9			
5.0-5.4				5.0-5.4			
5.5-5.9				5.5-5.9			
6.0-6.4				6.0-6.4			
6.5-6.9				6.5-6.9			
7.0-7.4				7.0-7.4			
7.5-7.9				7.5-7.9			
8.0-8.4				8.0-8.4			
8.5-8.9				8.5-8.9			
9.0-9.4				9.0-9.4			
9.5-9.9				9.5-9.9			
10.0-10.4				10.0-10.4			
10.5-10.9				10.5-10.9			
11.0-11.4				11.0-11.4			
11.5-11.9				11.5-11.9			
12.0-12.4				12.0-12.4			
12.5-12.9				12.5-12.9			
13.0-13.4				13.0-13.4			
13.5-13.9				13.5-13.9			
14.0-14.4				14.0-14.4			
14.5-14.9				14.5-14.9			
15.0-15.4				15.0-15.4			
15.5-15.9				15.5-15.9			
16.0-16.4				16.0-16.4			
16.5-16.9				16.5-16.9			
17.0-17.4				17.0-17.4			
17.5-17.9				17.5-17.9			
18.0-18.4				18.0-18.4			
18.5-18.9				18.5-18.9			
19.0-19.4				19.0-19.4			
19.5-19.9				19.5-19.9			
TOTALS:	16	10		TOTALS:	7		
COUNTS:				COUNTS:			

1 MU 28 Lem

FALL GAMEFISH ELECTROFISHING DATA COLLECTION SHEET

GAMEFISH

Wisconsin Department of Natural Resources

Waterbody Name: Milford
 MWB Code/WBIC: 1004000
 Waterbody Type: Lake
 County: Owasha
 Date (MM/DD/YY): 6-4-14
 Station: B
 Start Time: 2147
 End Time: 2233
 Collectors: Timber
Krisiak
Andrew

Target Fish: Gamefish
 Mark(s) Given: None
 Survey Type: -CPE (Spring Shoreline) - Beachline
 Gear Type: Boomshocker
 Weather: Partly Cloudy warm calm
 Adverse Conditions: Low conductivity, low water
 Water Temperature: 67
 Water Conductivity: 18
 Water Level: [HI] & [NORM] (LOW)
 Water Clarity: 80

Generator Start Time: _____
 Generator End Time: _____
 Volts: 534
 Amps: 1.5
 Pulse Rate: _____
 Duty Cycle: _____
 Current Type: (AC) [DC], [PDC]
 Distance Shocked: 75m
 Entire Shoreline Shocked: (M) [N] [I]
 Number of Dippers: [1], [2]
 Dipnet Mesh Size: 3/8 bail

Inches	Northern Pike		Muskellunge		Largemouth Bass		Smallmouth Bass		inches	Northern Pike		Muskellunge	
	Unclipped	Clipped	Unclipped	Clipped	Unclipped	Clipped	Unclipped	Clipped		Unclipped	Clipped	Unclipped	Clipped
<1.5									24.5-24.9				
1.5-1.9									25.0-25.4				
2.0-2.4									25.5-25.9				
2.5-2.9									26.0-26.4				
3.0-3.4									26.5-26.9				
3.5-3.9									27.0-27.4				
4.0-4.4									27.5-27.9				
4.5-4.9									28.0-28.4				
5.0-5.4									28.5-28.9				
5.5-5.9									29.0-29.4				
6.0-6.4									29.5-29.9				
6.5-6.9									30.0-30.4				
7.0-7.4									30.5-30.9				
7.5-7.9									31.0-31.4				
8.0-8.4									31.5-31.9				
8.5-8.9									32.0-32.4				
9.0-9.4									32.5-32.9				
9.5-9.9									33.0-33.4				
10.0-10.4									33.5-33.9				
10.5-10.9									34.0-34.4				
11.0-11.4									34.5-34.9				
11.5-11.9									35.0-35.4				
12.0-12.4									35.5-35.9				
12.5-12.9									36.0-36.4				
13.0-13.4									36.5-36.9				
13.5-13.9									37.0-37.4				
14.0-14.4									37.5-37.9				
14.5-14.9									38.0-38.4				
15.0-15.4									38.5-38.9				
15.5-15.9									39.0-39.4				
16.0-16.4									39.5-39.9				
16.5-16.9									40.0-40.4				
17.0-17.4									40.5-40.9				
17.5-17.9									41.0-41.4				
18.0-18.4									41.5-41.9				
18.5-18.9									42.0-42.4				
19.0-19.4									42.5-42.9				
19.5-19.9									43.0-43.4				
20.0-20.4									43.5-43.9				
20.5-20.9									44.0-44.4				
21.0-21.4									44.5-44.9				
21.5-21.9									45.0-45.4				
22.0-22.4									45.5-45.9				
22.5-22.9									46.0-46.9				
23.0-23.4									47.0-47.9				
23.5-23.9									48.0-48.9				
24.0-24.4									49.0-49.9				
TOTALS									50.0+				

Waterbody Name: Mildred
 MWB Code/WBIC: 004600
 Waterbody Type: Lake
 County: Oncida
 Date (MM/DD/YY): 10-4-14
 Station: 2
 Start Time: 2249
 End Time: 2307
 Collectors: Tim Lov
Kristal
Andrew

Target Fish: All species
 Mark(s) Given: none
 Survey Type: CPE (Fall Shoreline) Ecolim
 Gear Type: Boomsucker
 Weather: partly cloudy warm calm
 Adverse Conditions: low water low conductivity
 Water Temperature: 10.7
 Water Conductivity: 18
 Water Level: [HI] [NORM] [LOW]
 Water Clarity: 80+
 Substrate Type: _____

Generator Start Time: _____
 Generator End Time: _____
 Volts: 5.34
 Amps: 1.5
 Pulse Rate: _____
 Duty Cycle: _____
 Current Type: (AC) [DC] [PDC]
 Distance Shocked: 1.5 m
 Entire Shoreline Shocked: (Y) [N] [I]
 Number of Dippers: (1) (2)
 Dipnet Mesh Size: 7/8 inch

SPECIES				SPECIES			
INCHES	SMB	Breath		INCHES	Green Sunfish	LMB	
0.0-0.4				0.0-0.4			
0.5-0.9				0.5-0.9			
1.0-1.4				1.0-1.4			
1.5-1.9				1.5-1.9			
2.0-2.4				2.0-2.4			
2.5-2.9				2.5-2.9			
3.0-3.4				3.0-3.4			
3.5-3.9				3.5-3.9			
4.0-4.4				4.0-4.4			
4.5-4.9				4.5-4.9			
5.0-5.4				5.0-5.4			
5.5-5.9				5.5-5.9			
6.0-6.4				6.0-6.4			
6.5-6.9				6.5-6.9			
7.0-7.4				7.0-7.4			
7.5-7.9				7.5-7.9			
8.0-8.4				8.0-8.4			
8.5-8.9				8.5-8.9			
9.0-9.4				9.0-9.4			
9.5-9.9				9.5-9.9			
10.0-10.4				10.0-10.4			
10.5-10.9				10.5-10.9			
11.0-11.4				11.0-11.4			
11.5-11.9				11.5-11.9			
12.0-12.4				12.0-12.4			
12.5-12.9				12.5-12.9			
13.0-13.4				13.0-13.4			
13.5-13.9				13.5-13.9			
14.0-14.4				14.0-14.4			
14.5-14.9				14.5-14.9			
15.0-15.4				15.0-15.4			
15.5-15.9				15.5-15.9			
16.0-16.4				16.0-16.4			
16.5-16.9				16.5-16.9			
17.0-17.4				17.0-17.4			
17.5-17.9				17.5-17.9			
18.0-18.4				18.0-18.4			
18.5-18.9				18.5-18.9			
19.0-19.4				19.0-19.4			
19.5-19.9				19.5-19.9			
TOTALS:	9	11		TOTALS:	17	7	
COUNTS:				COUNTS:			

Green Sunfish
 *22
 2.1
 (2)

FALL GAMEFISH ELECTROFISHING DATA COLLECTION SHEET

GAMEFISH

Wisconsin Department of Natural Resources

Waterbody Name: Mildred
 MWB Code/WBIC: 1004600
 Waterbody Type: Lake
 County: Oneida
 Date (MM/DD/YY): 10-4-14
 Station: D
 Start Time: 23:19
 End Time: 00:44
 Collectors: Tim Lovvick
Kubisaik
Andrew

Target Fish: Gamefish
 Mark(s) Given: None
 Survey Type: GPE (Spring Shoreline) Beachline
 Gear Type: Boomshocker
 Weather: Partly cloudy, warm calm
 Adverse Conditions: low water, low conductivity
 Water Temperature: 67
 Water Conductivity: 18
 Water Level: [H] [NORM] [LOW] [LOW]
 Water Clarity: 8.0

Generator Start Time: _____
 Generator End Time: _____
 Volts: 534
 Amps: 15
 Pulse Rate: _____
 Duty Cycle: _____
 Current Type: [AC] [DC] [PDC] _____
 Distance Shocked: 2.66 mi
 Entire Shoreline Shocked: [M] [N] [I] _____
 Number of Dippers: [1] [12] _____
 Dipnet Mesh Size: 360

*Mr. Ables
 2-1-15*

Inches	Northern Pike		Muskellunge		Largemouth Bass		Smallmouth Bass		Inches	Northern Pike		Muskellunge	
	Uncollected	Collected	Uncollected	Collected	Uncollected	Collected	Uncollected	Collected		Uncollected	Collected	Uncollected	Collected
<1.5									24.5-24.9				
1.5-1.9									25.0-25.4				
2.0-2.4									25.5-25.9				
2.5-2.9									26.0-26.4				
3.0-3.4									26.5-26.9				
3.5-3.9									27.0-27.4				
4.0-4.4									27.5-27.9				
4.5-4.9									28.0-28.4				
5.0-5.4									28.5-28.9				
5.5-5.9									29.0-29.4				
6.0-6.4									29.5-29.9				
6.5-6.9									30.0-30.4				
7.0-7.4									30.5-30.9				
7.5-7.9									31.0-31.4				
8.0-8.4									31.5-31.9				
8.5-8.9									32.0-32.4				
9.0-9.4									32.5-32.9				
9.5-9.9									33.0-33.4				
10.0-10.4									33.5-33.9				
10.5-10.9									34.0-34.4				
11.0-11.4									34.5-34.9				
11.5-11.9									35.0-35.4				
12.0-12.4									35.5-35.9				
12.5-12.9									36.0-36.4				
13.0-13.4									36.5-36.9				
13.5-13.9									37.0-37.4				
14.0-14.4									37.5-37.9				
14.5-14.9									38.0-38.4				
15.0-15.4									38.5-38.9				
15.5-15.9									39.0-39.4				
16.0-16.4									39.5-39.9				
16.5-16.9									40.0-40.4				
16.5-16.9									40.5-40.9				
17.0-17.4									41.0-41.4				
17.5-17.9									41.5-41.9				
18.0-18.4									42.0-42.4				
18.5-18.9									42.5-42.9				
19.0-19.4									43.0-43.4				
19.5-19.9									43.5-43.9				
20.0-20.4									44.0-44.4				
20.5-20.9									44.5-44.9				
21.0-21.4									45.0-45.4				
21.5-21.9									45.5-45.9				
22.0-22.4									46.0-46.9				
22.5-22.9									47.0-47.9				
23.0-23.4									48.0-48.9				
23.5-23.9									49.0-49.9				
24.0-24.4									50.0+				
TOTALS													